

MANAGED
WORKSPACE
OPPORTUNITY



1-3 MOUNT ST,
W1K

3,370 SQ. FT

REDEFINING THE
TRADITIONAL

REIMAGINED WORKSPACE

Connaught House built in the early 1970's and is arranged over basement, ground and five upper floors. The floor offers fully fitted and cabled office accommodation. The space currently provides 20 open plan workstations, 1 x 10 person boardroom, 1 x 6 person meeting room, 5 x executive offices, 1 x 3 person office, 2 x call booths, reception and kitchen.

BUILDING LOCATION



Location

Connaught House,
1-3 Mount St,
London
W1K 3NB

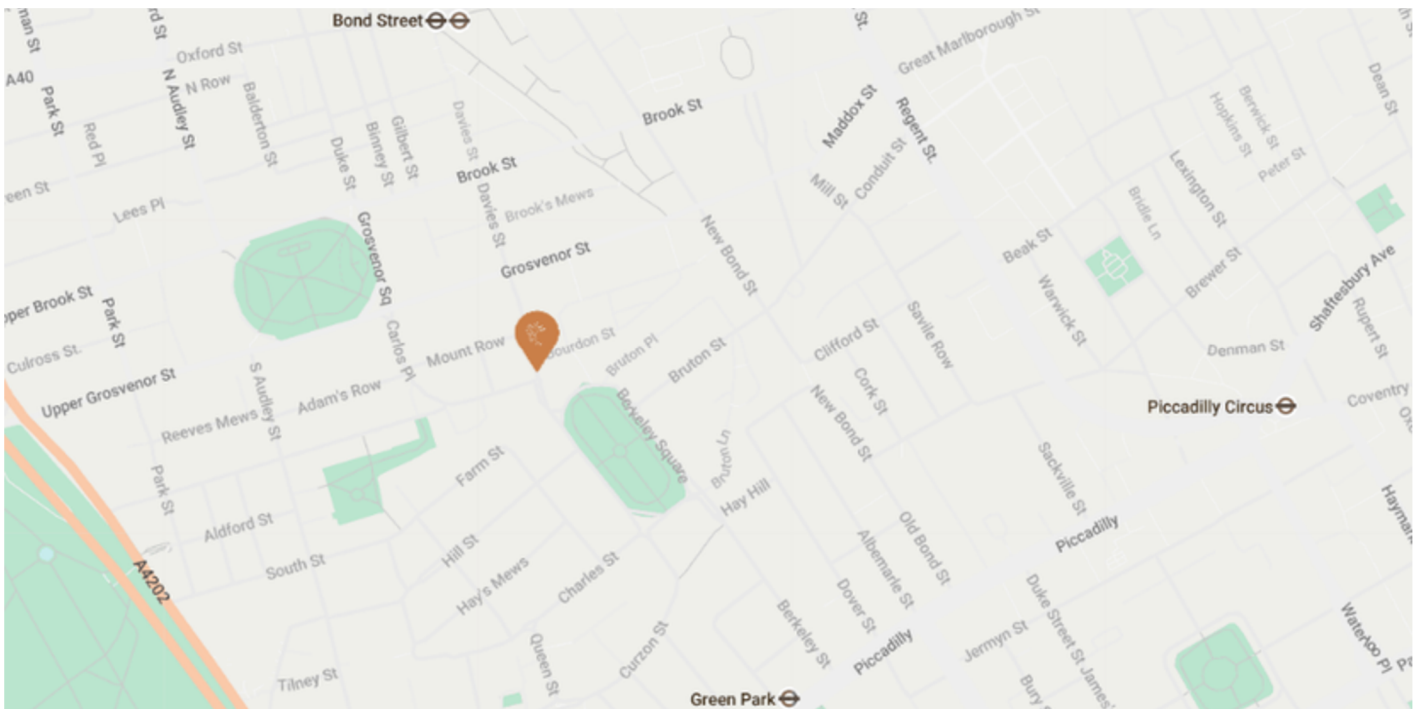

Connaught House is located on the north western corner of the world renowned Berkeley Square, situated on an island site with frontages to Davies Street, Mount Street, Mount Row and Carpenter Street. The building is a short walk to Green Park (Jubilee, Piccadilly and Victoria Lines) and Bond Street (Jubilee and Piccadilly Lines) underground Stations.

OFFICE AMENITIES



Air Conditioning



Kitchen Areas



Manned Reception



Showers & Changing
Facilities



Meeting Rooms



Passenger Lift



Existing Fit Out

Design your space reflecting you
and your business in an
attractive property.

WHAT CAN BE INCLUDED AT YOUR CHOICE



PROPERTY EXPENDITURE

Rent
Rates
Service Charges
Insurances

CAPITAL EXPENDITURE

Building Surveys
Design & Fit-Out Works*
Furniture Fixtures & Fittings
Stamp Duty Land Tax
Legal Fees & Property Searches
Acquisition Fees

OPERATIONAL EXPENDITURE

Utilities
Cleaning & Waste Disposal
Facilities Management
Repairs & Maintenance
Health & Safety & Compliance
Security
IT Connectivity

Location

Connaught House,
1-3 Mount St,
London
W1K 3NB



*To a Pre-Agreed Value

PRICING

PER SQ. FT
FROM **£246**

LICENCE FEE PCM
FROM **£69,100 + VAT**

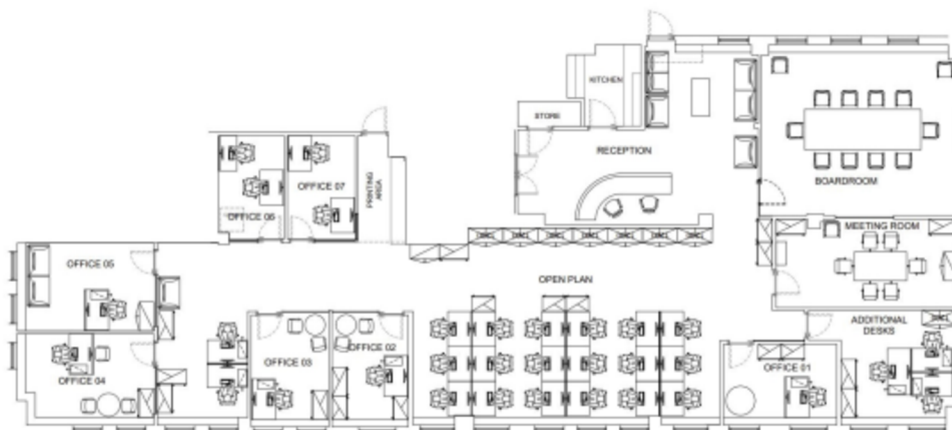



IDENTITY

workspace

FOR ENQUIRIES
CONTACT US

Telephone: 020 3988 8930

Email: enquiry@identityworkspace.com

Web: www.identityworkspace.com

Uniquely yours, managed by us